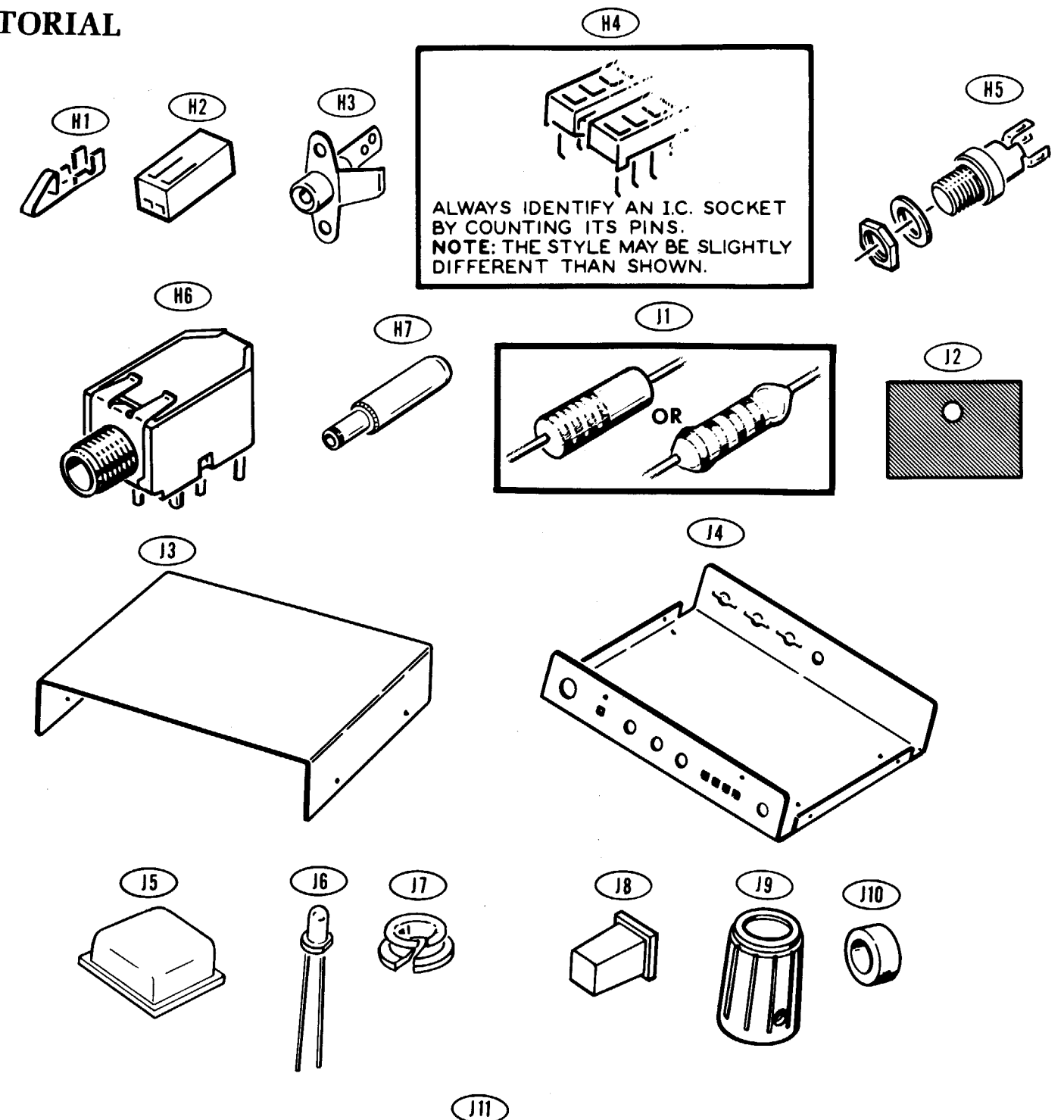
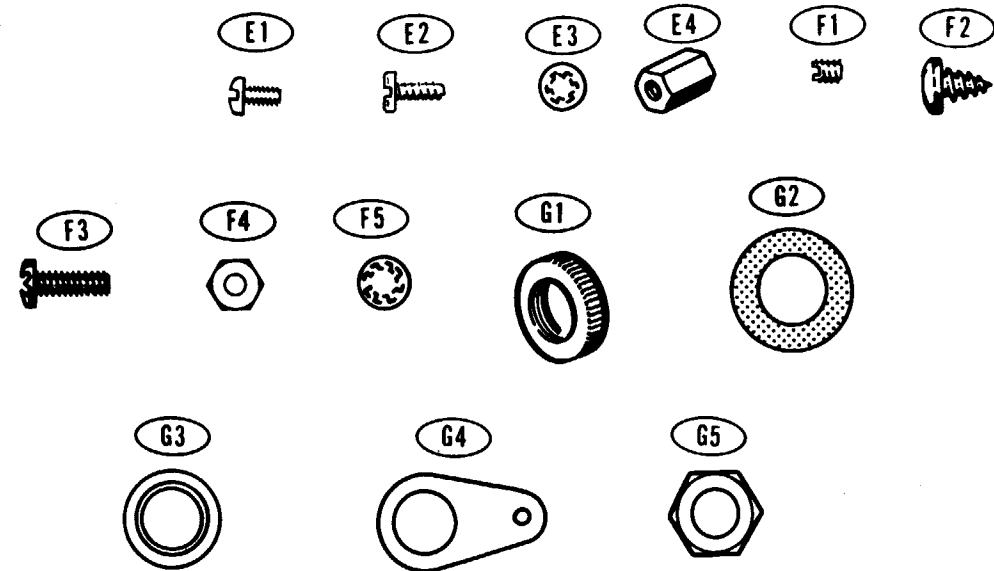
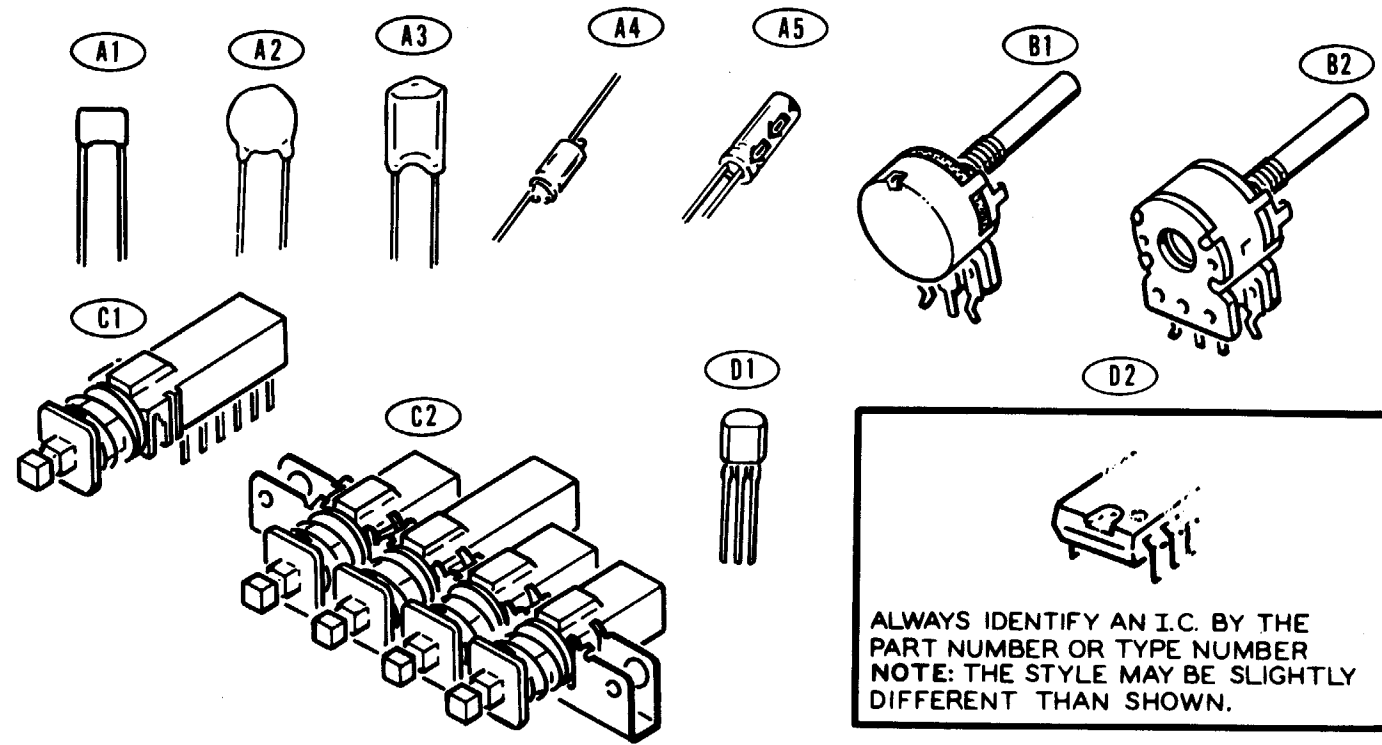

ILLUSTRATION BOOKLET

Part of 595-2980

PARTS PICTORIAL



Model HD-1418

Copyright © 1983
 Heath Company
 All Rights Reserved
 Printed in the United States of America

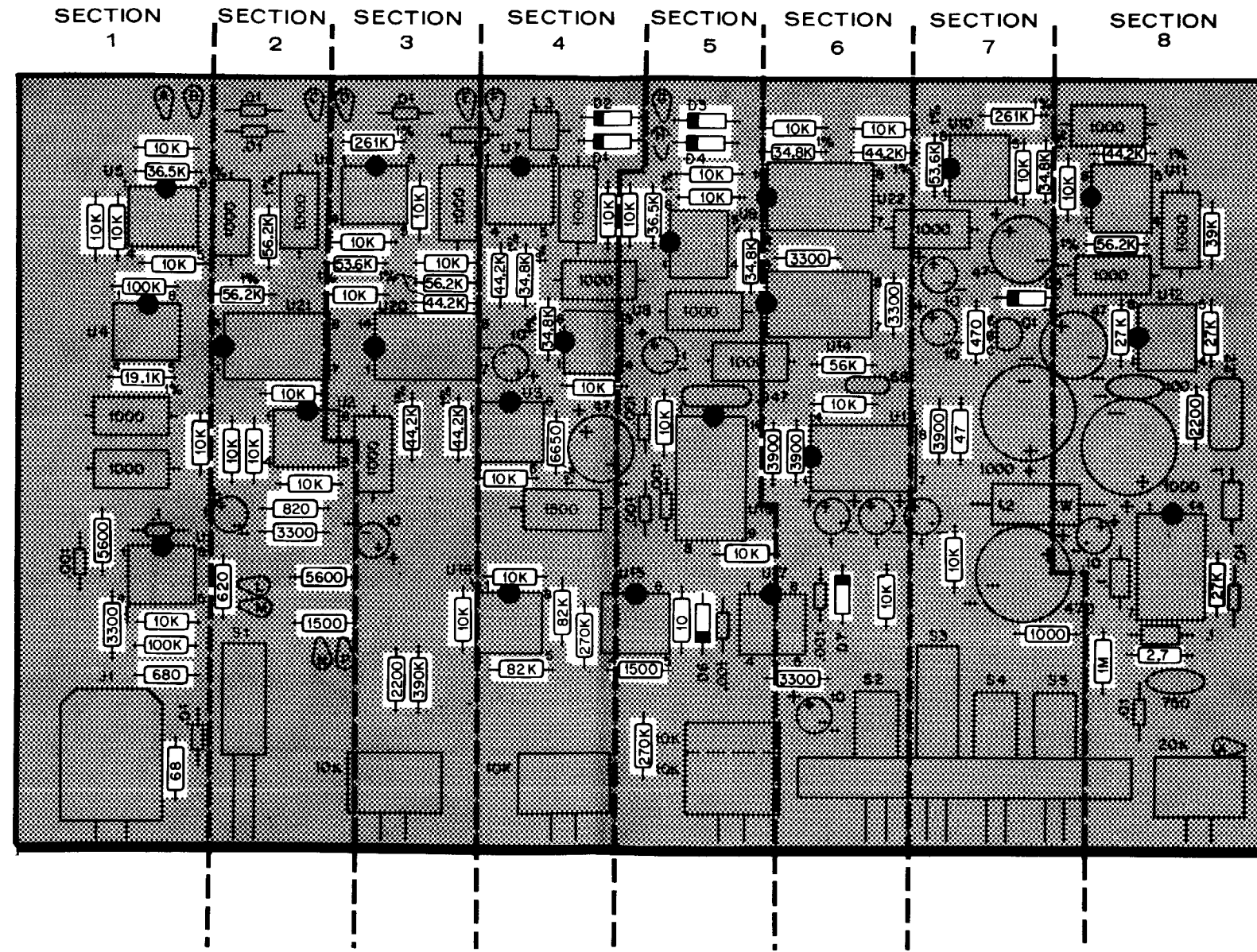

PICTORIAL 1-1

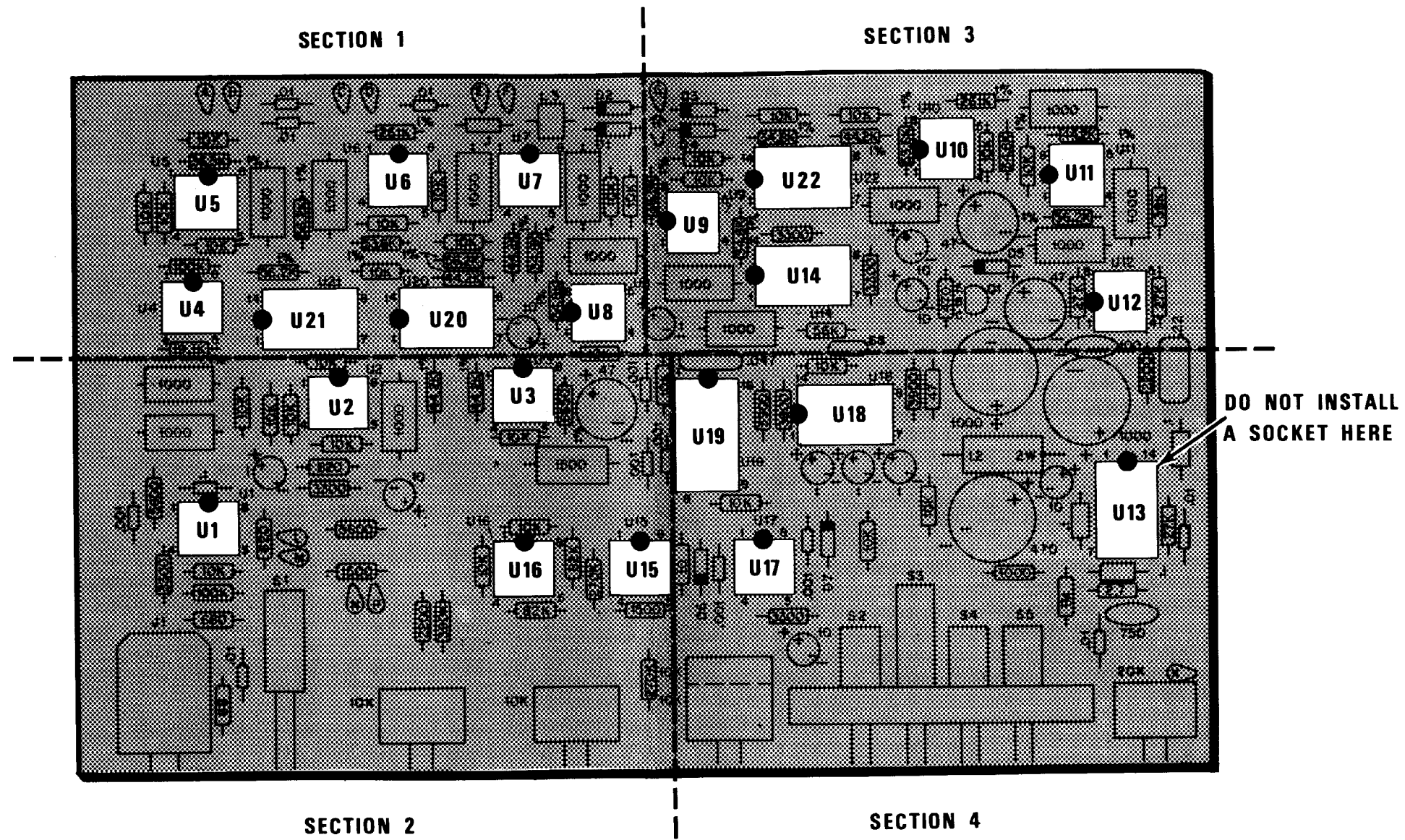

PICTORIAL 1-2

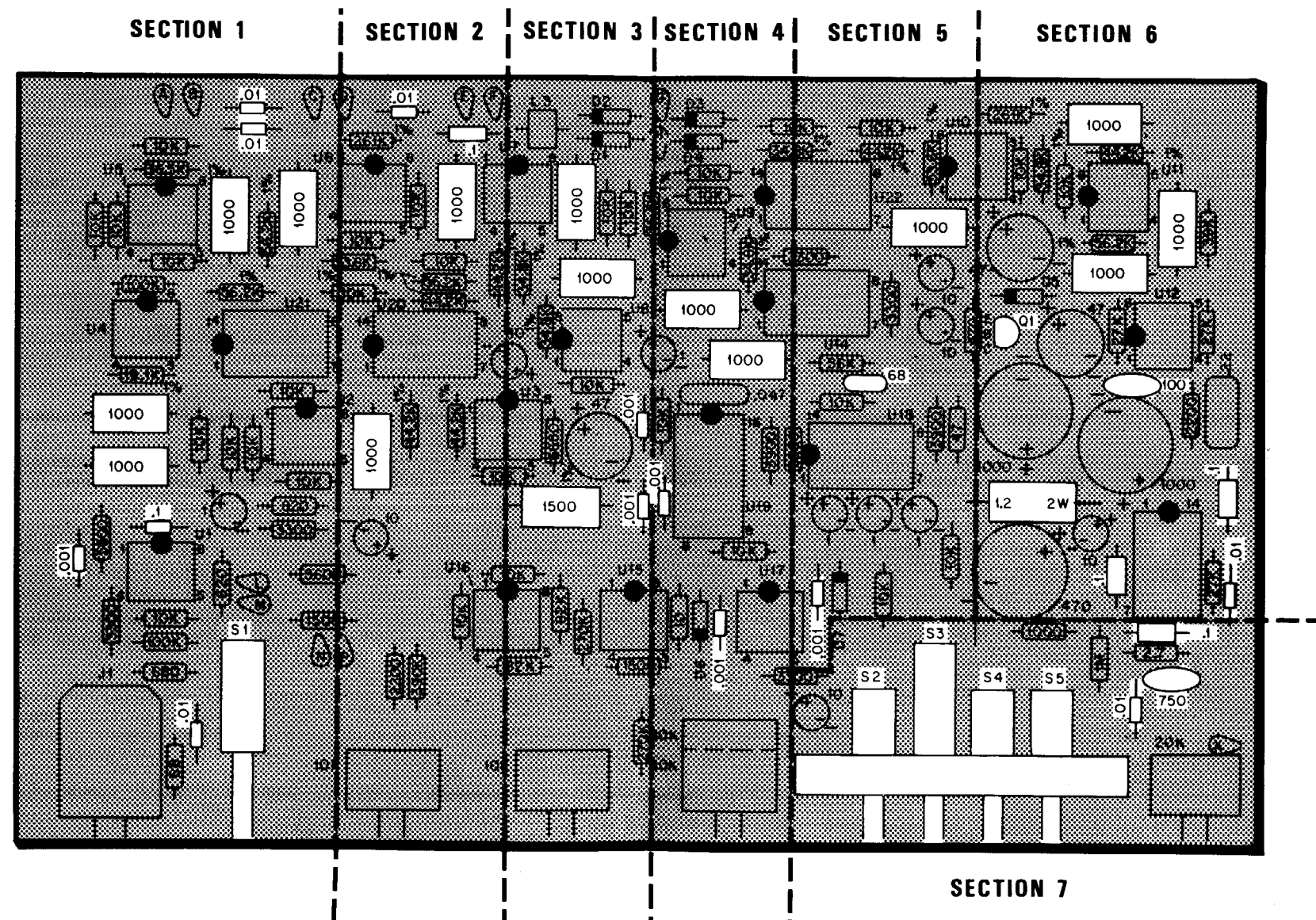

PICTORIAL 1-3

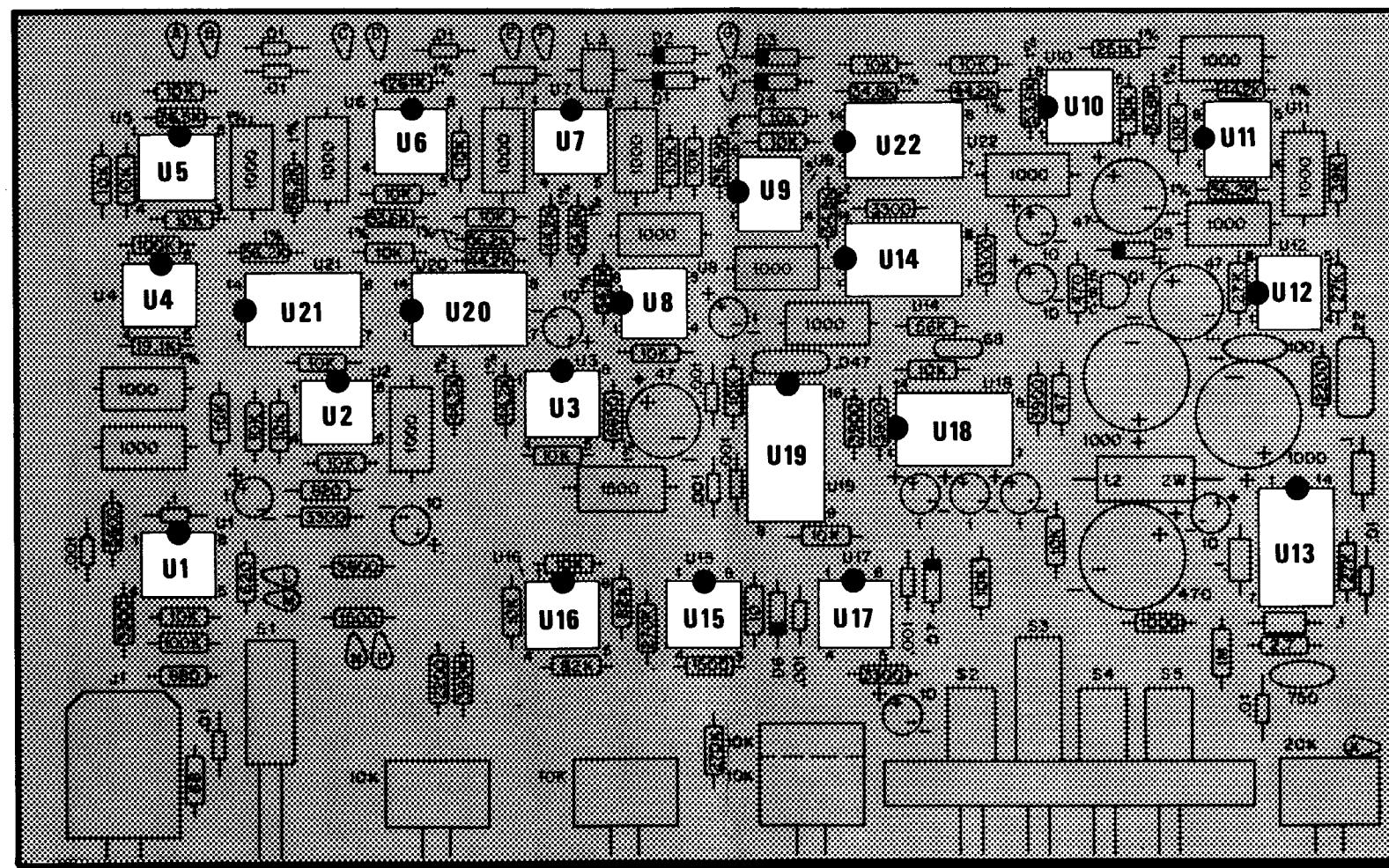

PICTORIAL 1-4

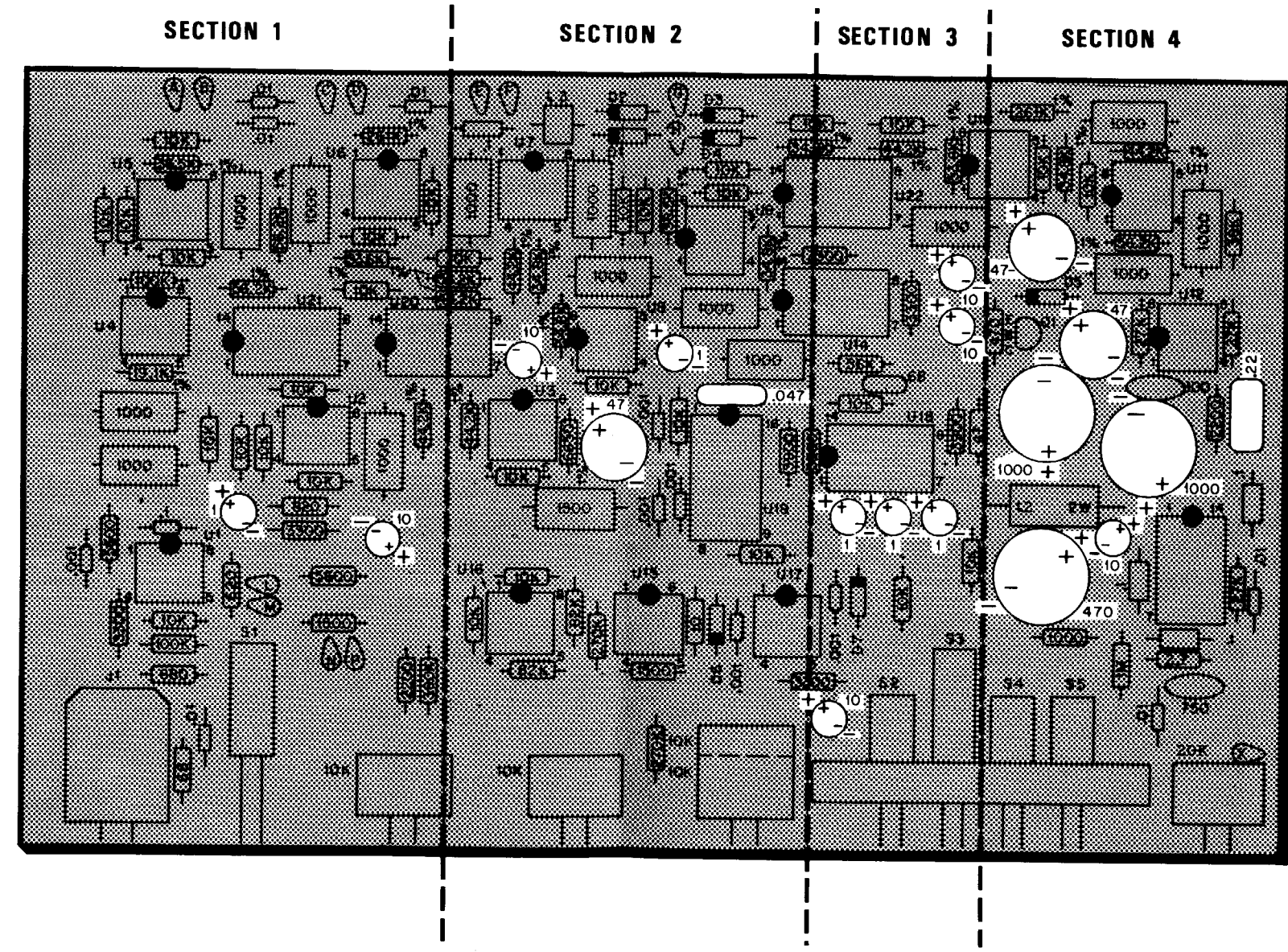

PICTORIAL 1-5

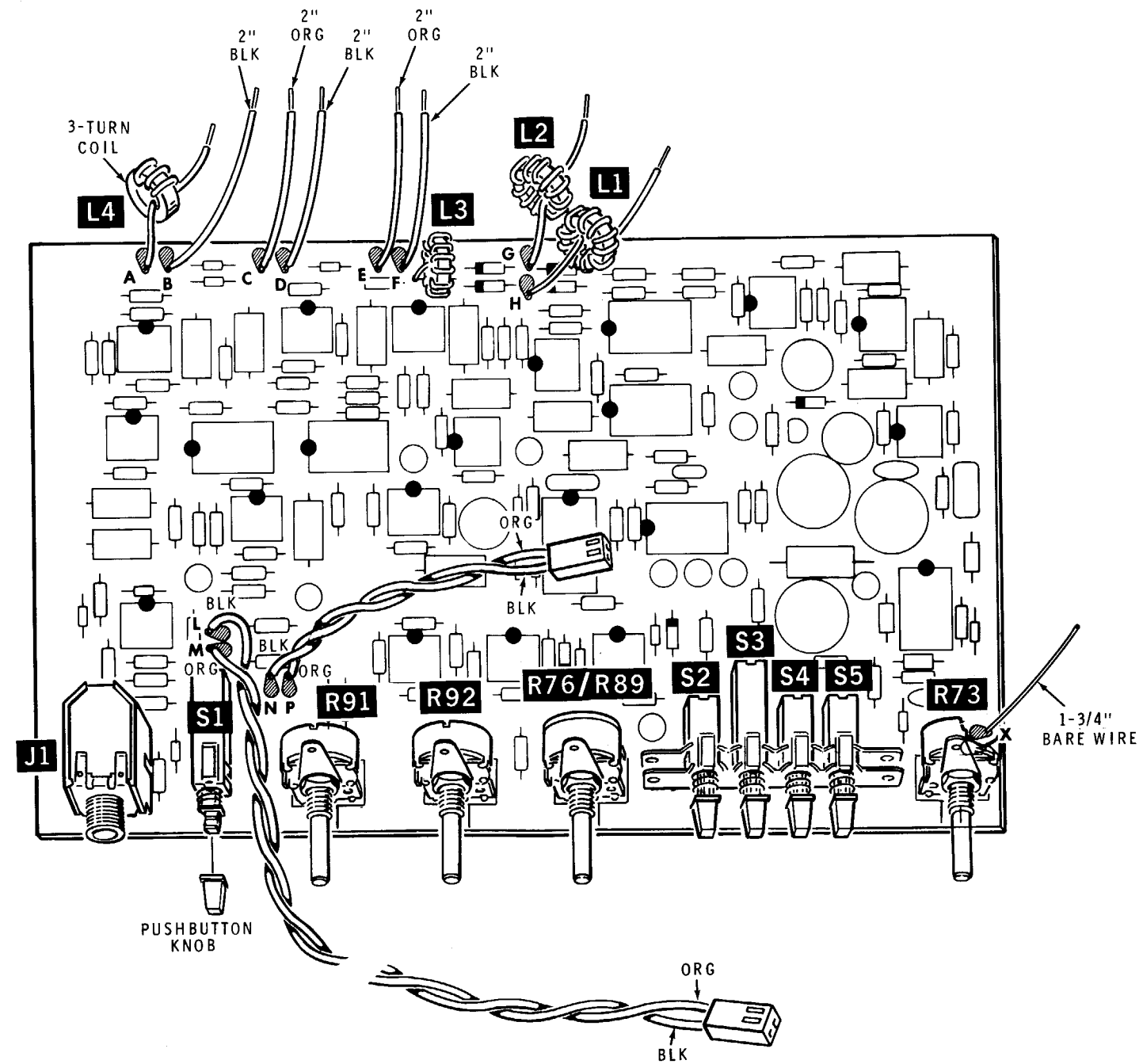

PICTORIAL 1-6

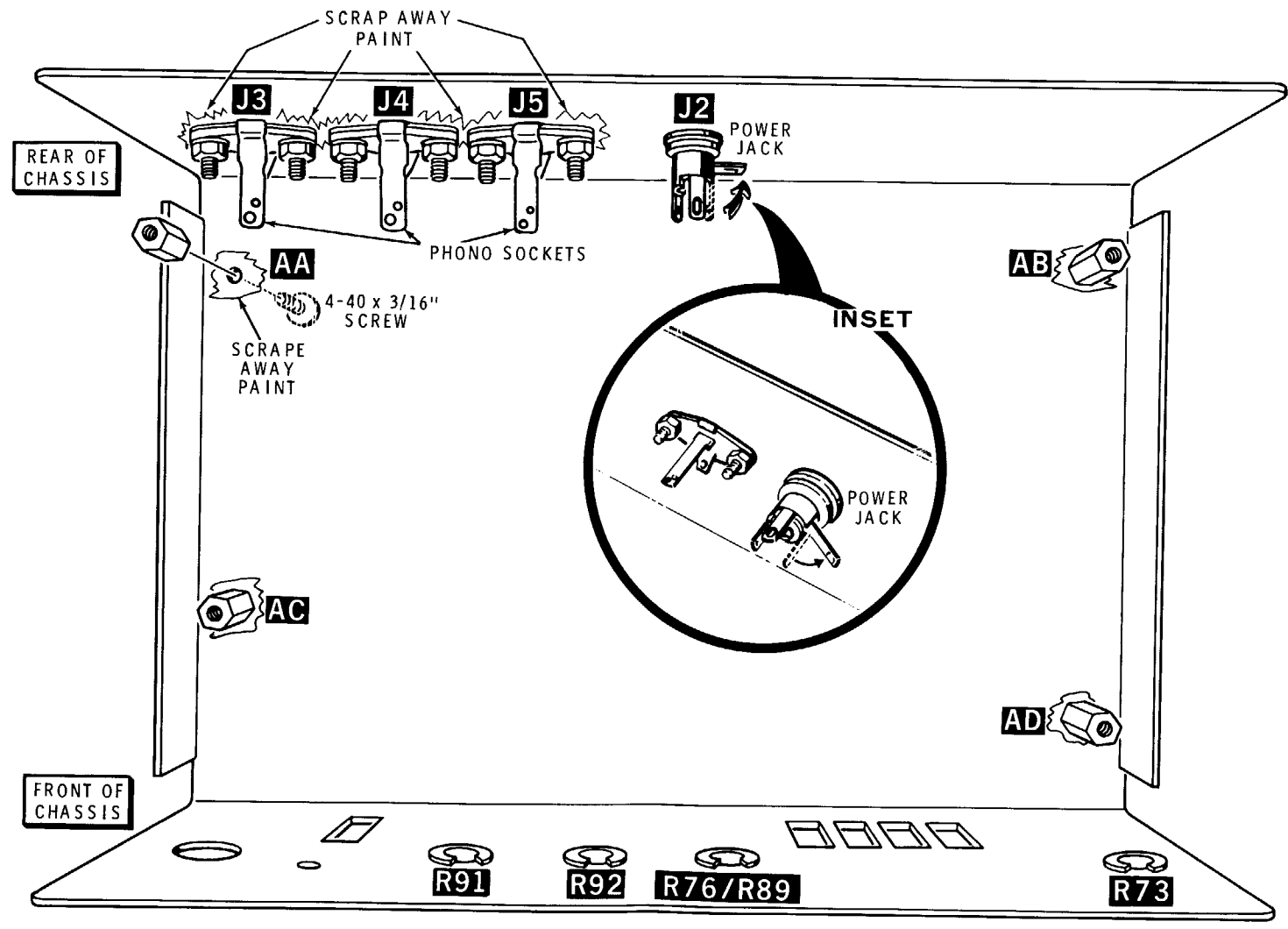

PICTORIAL 1-7

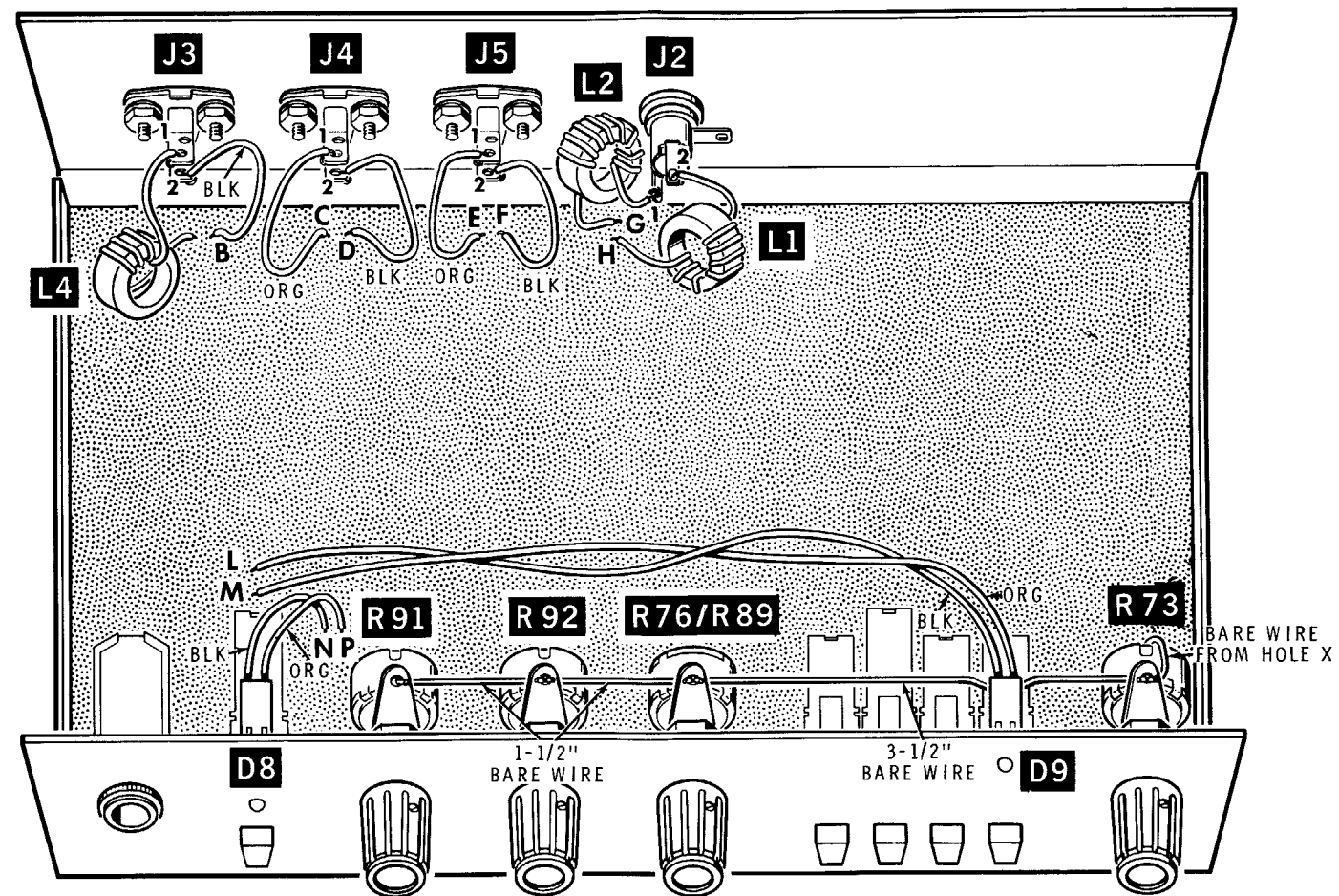

PICTORIAL 1-8

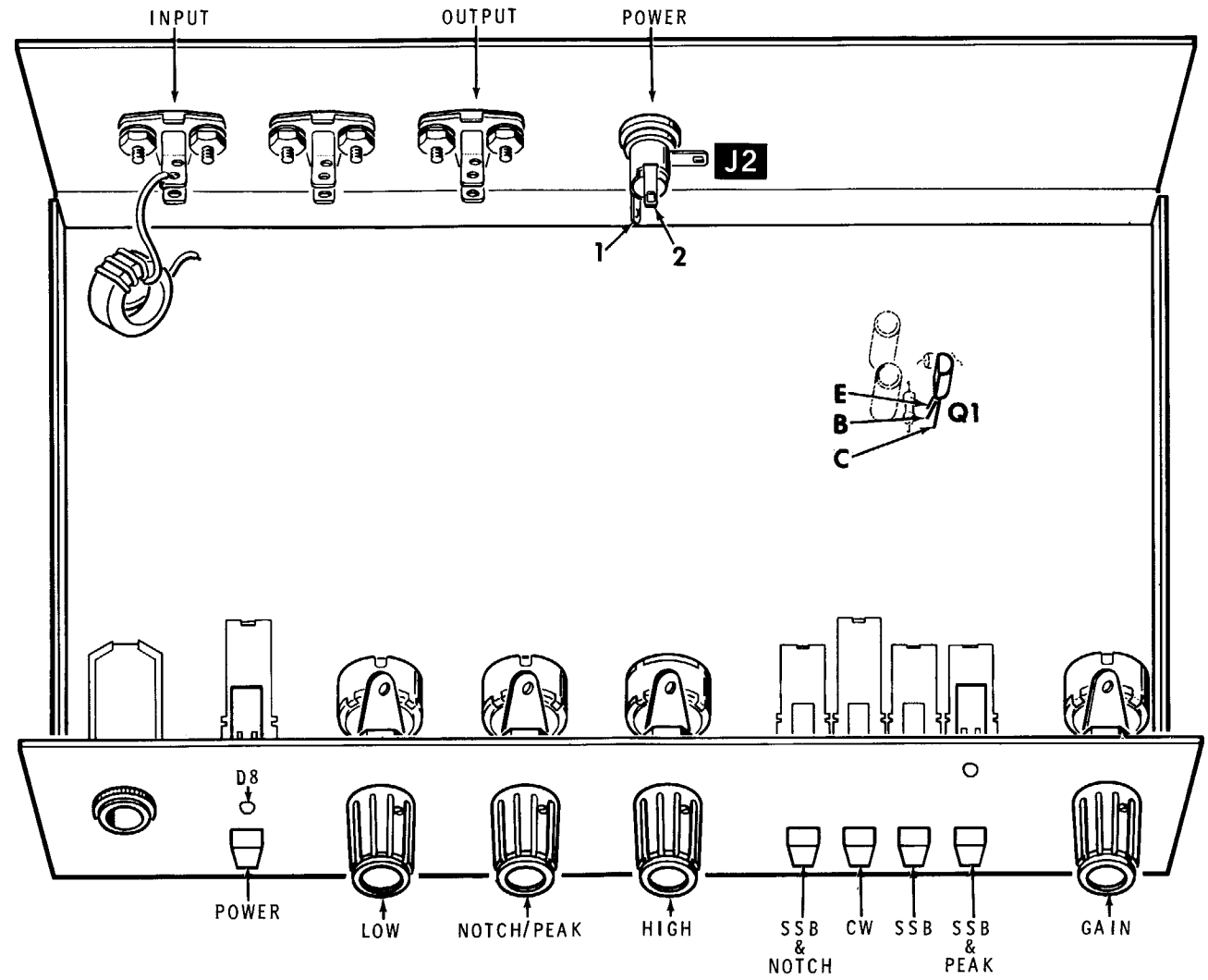

PICTORIAL 2-1

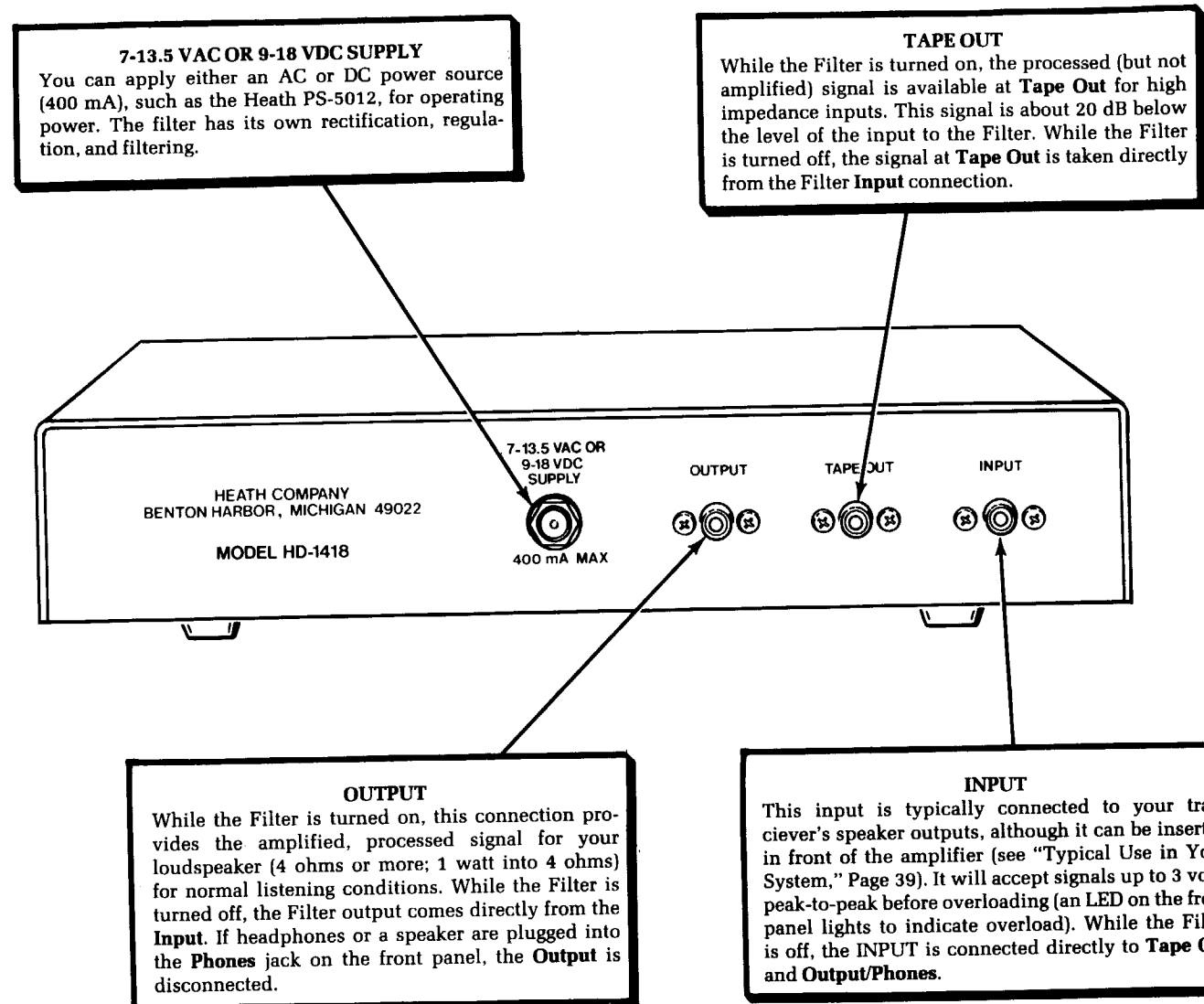

PICTORIAL 4-1

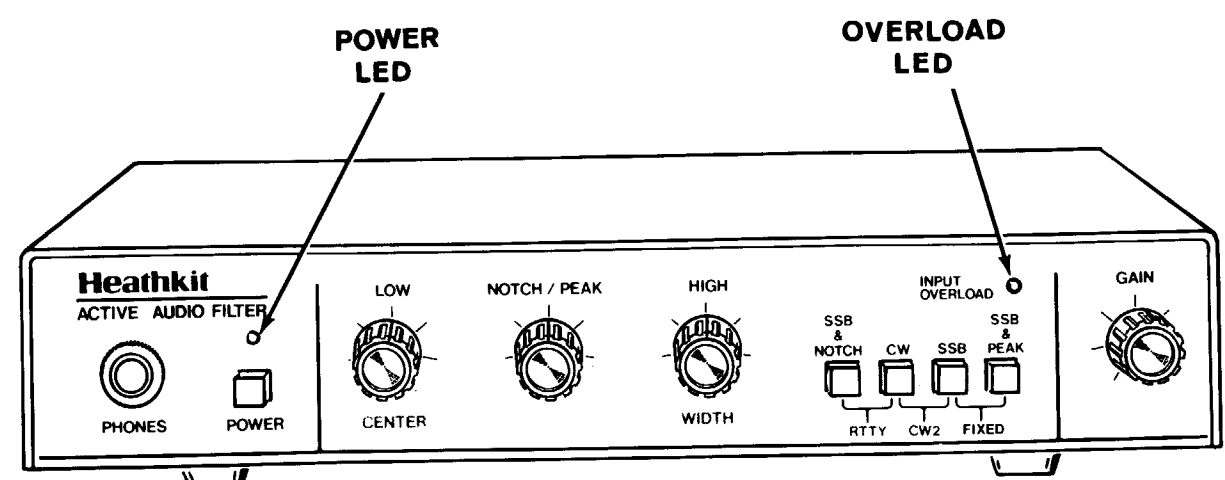

PICTORIAL 4-2

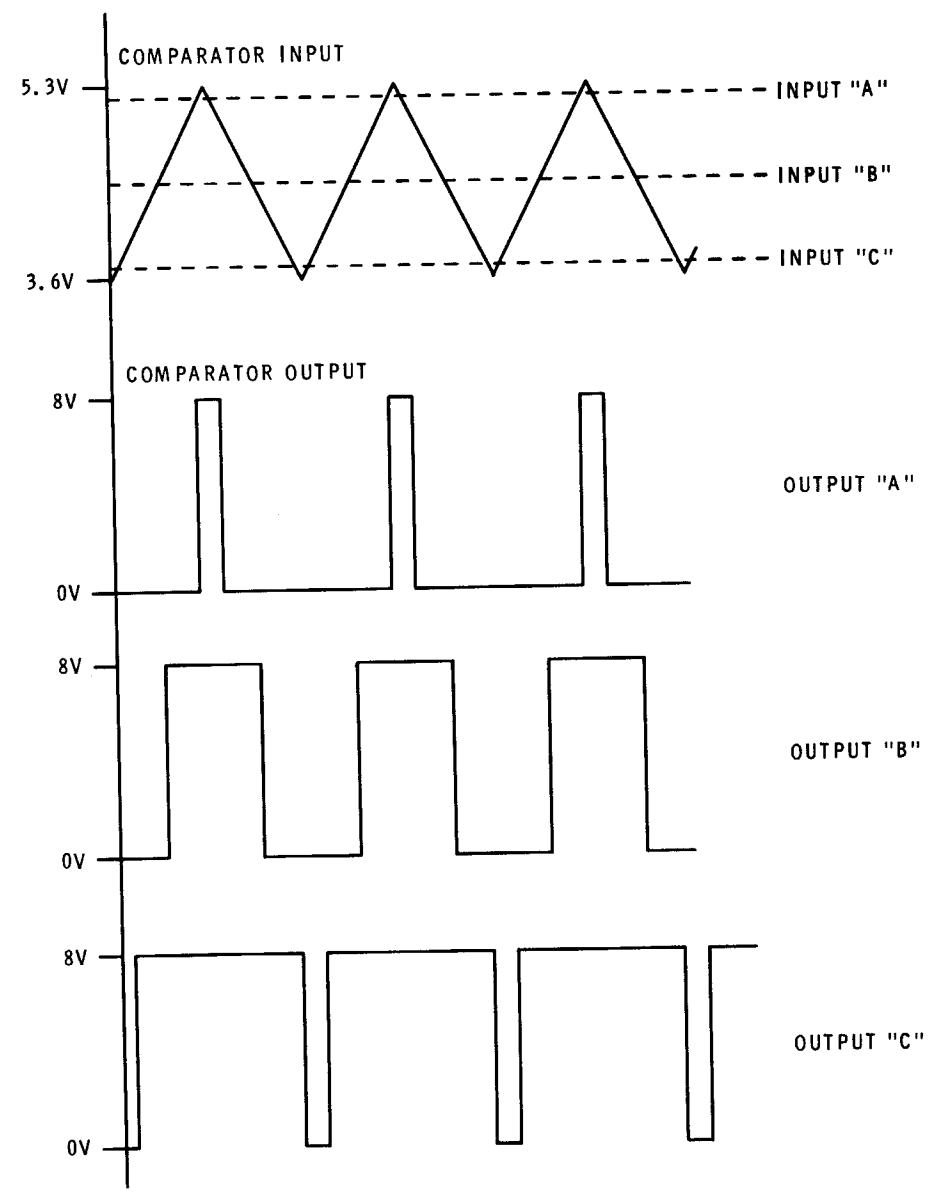

POSITION "A": CONTROL TURNED CCW
POSITION "B": CONTROL CENTERED
POSITION "C": CONTROL TURNED CW

PICTORIAL 5-1

CIRCUIT BOARD X-RAY VIEW

NOTE: To find the PART NUMBER of a component for the purpose of ordering a replacement part:

- A. Find the circuit board number (R5, C3, etc.) on the X-Ray View.
- B. Locate this same number in the "Circuit Component Number" column of the "Parts List."
- C. Adjacent to the circuit component number, you will find the PART NUMBER and DESCRIPTION which must be supplied when you order a replacement part.

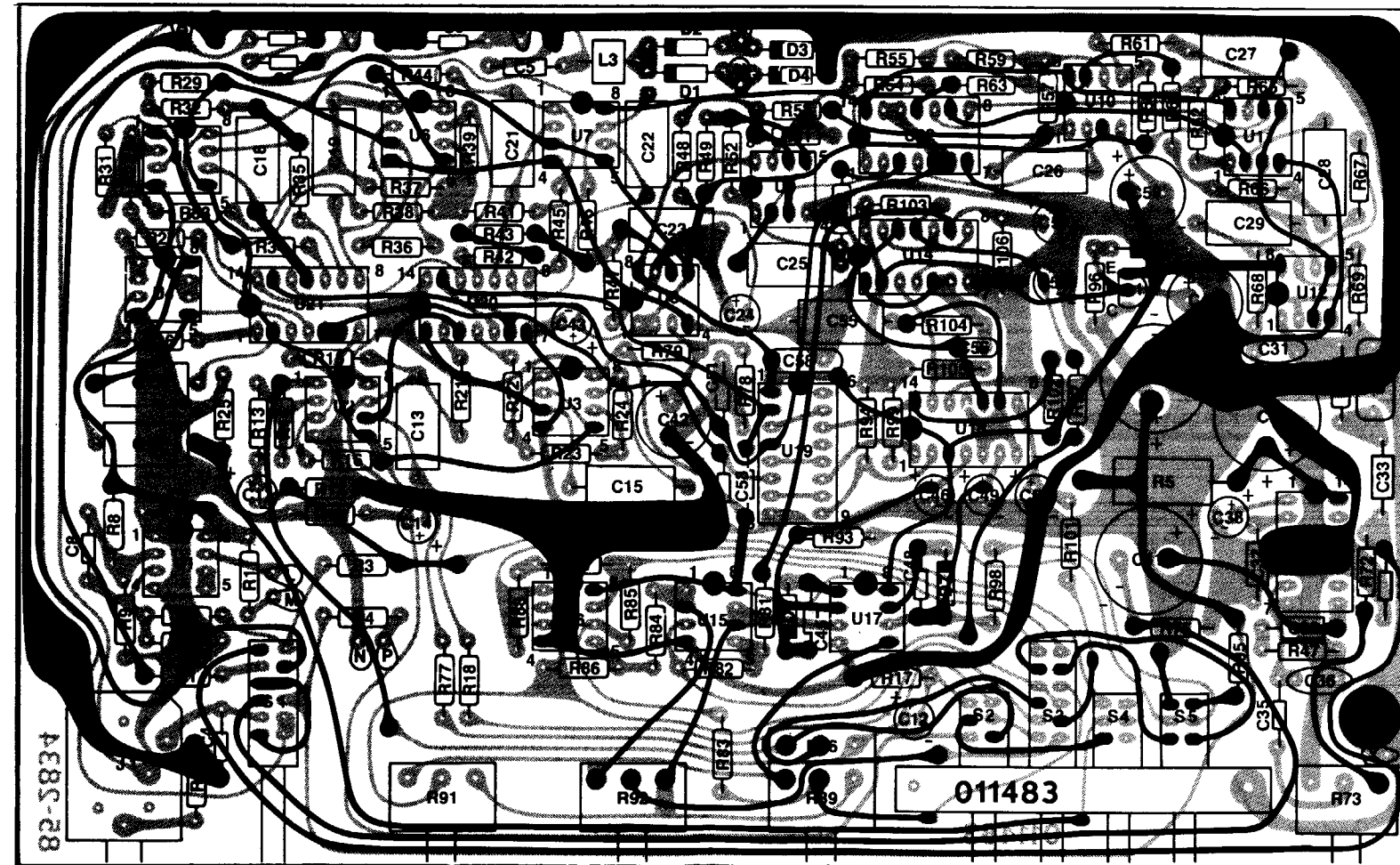

(Shown from the component side.
The foil on the component side is shown in red.)