

Cat. No. 19-1127
OWNER'S MANUAL

Please read before using this equipment.

HTX-252

**2-Meter Amateur
FM Mobile Transceiver**



RadioShack®

FEATURES

Your RadioShack HTX-252 2-Meter FM Mobile Transceiver is a compact and versatile transceiver, perfect either in your vehicle or in your home. Vehicle cables and mounting hardware are supplied. Add an optional base-station antenna, cable, and a power supply to make it your home transceiver. It is an all-around ideal choice for your amateur communications needs.

Note: You must have a Technician Class or higher Amateur Radio Operator's License and a call sign issued by the FCC to legally transmit using this transceiver. Transmitting without a license carries heavy penalties. Getting a license is easier than ever. See "Introduction to Amateur Radio" on Page 7 for more information.

Here are some of your transceiver's features.

High (25 Watt) and Low (10 Watt) Power Settings — let you select the best power setting according to communication guidelines.

10 Memory Channels and 1 Call Channel — let you store up to 10 frequencies for quick access along with other settings such as the repeater offset and the CTCSS tones.

Frequency Range of 144–148 MHz (TX) and 136–174 MHz (RX) — provide flexibility and excellent wide coverage. You can also extend the transmit frequency range to 142.00–149.885MHz.

Channel Up/Down and 16-Key DTMF on the Mic — lets you manually send DTMF (Dual-Tone, Multiple Frequency) tones to quickly access DTMF-access repeaters, autopatches, or other stations equipped with a DTMF page feature.

CTCSS (Continuous Tone Coded Squelch System) Subaudible Tone — both encodes and decodes 38 subaudible tones to help reduce interference from other nearby systems operating on the same frequency.

©2000 Tandy Corporation.
All Rights Reserved.

RadioShack is a registered trademark used by Tandy Corporation.

Programmable Frequency Step — lets you set the frequency step for tuning or scanning to 5, 10, 12.5, 15, 20, 25 kHz.

Signal Strength Indicator — a graduated bar shows the relative strength of the received signal and transmitting signal.

Digital Phase-Locked Loop (PLL) Frequency Synthesizer — provides highly accurate and stable tuning.

Built-In Automatic Modulation Control — ensures a constant RF modulation level.

Repeater Offset — lets you select the appropriate offset value to match a local repeater.

Scan — the transceiver scans the frequency range and the memory locations for transmissions.

Rotary Tuning — lets you reach a desired frequency quickly and accurately.

External Speaker Jack — lets you connect an optional external speaker for more flexible operation.

Illuminated Digital Display — clearly shows the frequency, the functions, and the signal strength.

Key Lock — lets you lock the transceiver's keys to prevent accidentally changing settings.

MANUAL CONVENTIONS

Some of your transceiver's controls perform multiple functions. The abbreviation or symbol for a function is printed on, or above each multi-function button.

To activate certain transceiver features, you must press **F** (function) and then another button. Those key combination instructions are printed as the first button name, +, then the second button name. For example, **F+LOCK** means press **F** then press **LOCK**.

Control names are printed in small, bold, capital letters such as **CALL** or **VFO**. Words, symbols, and numbers that appear on the display are printed using a distinctive typeface, such as **146.94** or **BUSY**.

FCC INFORMATION

This device complies with Part 15 of the *FCC Rules*. Operation is subject to the following two conditions: (1) This device may not cause harmful interference, and (2) this device must accept any interference received, including interference that may cause undesired operation.

CONTENTS

Introduction to Amateur Radio	7
Preparation	9
Attaching the Microphone Holder	9
Mounting the Transceiver	9
Connecting an Antenna	11
Connecting the Microphone	12
Using an External Speaker	12
Connecting Power	13
Using the Transceiver as a Base Station	13
A Quick Look at the Controls	15
A Quick Look at the Display	18
Operation	19
Turning the Transceiver On and Off	19
Selecting Frequencies	19
Receiving Transmissions	20
Transmitting	20
Understanding Repeaters	22
Setting the Repeater Offset Frequency	23
Setting the Repeater Offset Direction	23
Reversing the Transmit and Receive Frequencies	24
Memory Operation	25
Storing a Transmit/Receive Frequency	25
Recalling Memories	25
Using the Calling-Frequency Memory	26
Scanning Operation	27
Scanning for Active Frequencies	27
Scanning Standard Memory Locations	27
Continuous Tone Coded Squelch System Features	28
Temporarily Opening Squelch	28
Using DTMF Tones	30

Other Special features	31
Using Priority Frequency Monitor	31
Using VFO Priority	31
Using Memory Priority	31
Changing the Transmit Frequency Range	32
Selecting the Transmit Power Level	32
Locking the Keypad	32
Turning the Key Tone On and Off	33
Setting the Frequency Step	33
Reducing Interference	33
Troubleshooting	35
Care and Maintenance	36
Resetting the Transceiver	37
Replacing the In-Line Fuse	37
Specifications	38

INTRODUCTION TO AMATEUR RADIO

This transceiver is the perfect first radio for anyone entering the exciting world of amateur radio, as well as a great additional transceiver for the experienced amateur radio operator. This transceiver opens a door for you to the world from almost anywhere! All you need is an Amateur Radio Operator's License (Technician Class or higher) issued by the Federal Communications Commission (FCC). If you do not have a license, it is easier than ever to get one, and help from licensed operators is available. Here are a few tips to help you get started.

You can turn on your transceiver and scan the entire band to hear what is going on; **however, do not attempt to transmit until you get your license.** If you transmit without a license, you are in violation of federal law that can lead to severe penalties. Note that ham operators take the FCC rules very seriously and want nothing to do with "bootleggers" — their term for people who operate without a license.

Find out if there is a ham radio club in your area. Most clubs welcome newcomers and are glad to help you get your license. There are thousands of clubs across the country, so there is probably one in or near your community. The staff at your local RadioShack store often can help you locate a club.

If you do not hear anyone talking about a local club as you listen to local transmissions, write to the American Radio Relay League (ARRL) at the following address to find out how to contact a local affiliate. The ARRL is the national organization representing amateur radio in the United States. The league has more than 150,000 members. Most are ham operators, or members in the process of obtaining their license.

The American Radio Relay League
225 Main Street
Newington, CT 06111

<http://www.arrl.org>

Start studying for the license exams. Do not be intimidated by the word “study,” because most people can go from knowing absolutely nothing about amateur radio to passing the Novice and Technician written exams in less than a month.

The exams test your knowledge of basic radio regulations and elementary radio theory. Many clubs hold license classes which can be a fun and easy way to learn about amateur radio. There are good books, cassette tapes, computer programs, and many other study aids available. Your local RadioShack store sells *FCC License Preparation* study guides for amateur radio operator licenses. While you are no longer required to learn Morse code for a Technician Class license, we encourage you to learn it anyway so you can advance to higher levels of operating privileges.

There is no fee to take the Novice exam. As soon as you pass the Novice exam, you can immediately take the Technician exam. There is a small fee required for taking the Technician exam. All license level tests are administered by a three-member Volunteer Examiner Team. Contact the ARRL for a schedule of exam opportunities in your area.

The Technician Class license lets you use this transceiver to communicate directly with other operators, and use repeaters for distant communication.

Amateur radio is a great hobby that has enriched the lives of millions of people all over the world. The ARRL would be glad to hear from you if you need more information or would like to join!

PREPARATION

ATTACHING THE MICROPHONE HOLDER

Follow these steps to attach the microphone holder to your vehicle.

1. Using the holder as a template, mark the position for the mounting screw holes at the desired location.
2. At each marked position, drill a hole slightly smaller than the supplied mounting screw.

Caution: Be careful not to drill into anything behind the mounting surface.

3. Use a Phillips screwdriver to attach the holder to the mounting location with the supplied small self-tapping sheet metal screws and lock-washers.

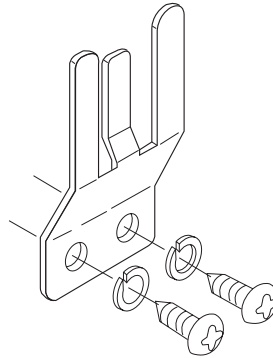

MOUNTING THE TRANSCEIVER

The most common mounting location for this transceiver is under a vehicle's dashboard. However, if you plan to use the transceiver as a base station, you can place it on a desk, shelf, or table (see "Using the Transceiver as a Base Station" on Page 13).

If you are mounting the transceiver in a vehicle, choose a location where:

- you can easily reach the transceiver
- wires and cables are clear of the vehicle's pedals or other moving parts
- the transceiver is not directly in front of heating vents
- all wires and cables can reach their connection points

Caution: If you use the transceiver in a vehicle, mount it securely to avoid damage to the transceiver or vehicle, or injury to anyone in the vehicle during sudden starts or stops.

Follow these steps to mount the transceiver.

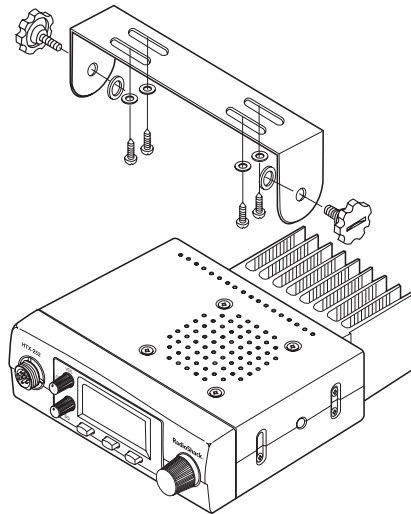

1. Using the mounting bracket as a template, mark the positions for the screw holes on the mounting surface,
2. In each marked location, drill a hole slightly smaller than the supplied self-tapping screws.

Caution: Be care not to drill into objects behind the mounting surface.

3. Using a Phillips screwdriver, attach the mounting bracket to the mounting surface with the supplied mounting screws and flat washers.
4. Attach the transceiver to the mounting bracket using the supplied rubber washers and mounting knobs.

CONNECTING AN ANTENNA

You must install an antenna before you can operate the transceiver. There are many different types of antennas suitable for transceiver use. Each has its own benefits, Choose the one best suited to your particular needs. Your local RadioShack store has a wide selection from which to choose.

Note: If you are using the transceiver as a base station, see “Using the Transceiver as a Base Station” on Page 13.

When you install an antenna, keep in mind that, for the best performance, you should mount the antenna vertically as high as possible on the vehicle and away from sources of electrical noise.

Once you choose an antenna, follow it’s mounting instructions. Then route the cable to the transceiver and thread the cable onto the **ANT** connector on the back of the transceiver.

Cautions:

- Avoid routing the cable next to sharp edges or moving parts, which might damage the cable.
- Do not run the cable next to power cables or other radio antenna cables.
- Do not run the cable through the engine compartment or other areas that produce extreme heat.

To take advantage of your transceiver’s maximum range, adjust the antenna’s standing wave ratio (SWR) using an SWR meter (not supplied, available at your local RadioShack store). Follow the instructions supplied with the SWR meter and antenna to adjust the antenna’s SWR. Values of 2.0:1 are generally acceptable, with readings of 1.5:1 or lower being more desirable.

CONNECTING THE MICROPHONE

1. Align the notch of the microphone's plug and the microphone's jack, located on the left side of the front panel. Then insert the plug and turn the metal ring clockwise to secure the plug.

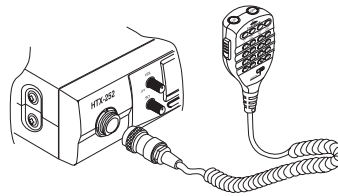

2. Slide the microphone onto the microphone holder.

To disconnect the microphone from the transceiver, turn the metal ring counterclockwise to loosen it.

Caution: Always disconnect the microphone by grasping its plug. Never pull on the coiled microphone cable.

USING AN EXTERNAL SPEAKER

To hear your communications better in a noisy environment, you can plug an optional, external speaker into the transceiver. The speaker should have an impedance of 8-ohms and be able to handle 3 to 10 watts of power. The speaker's cable should have a 1/8-inch (3.5-mm) plug.

To connect the speaker, insert the speaker cable's plug into **EXT. SP** on the back of the transceiver. This automatically disconnects the built-in speaker.

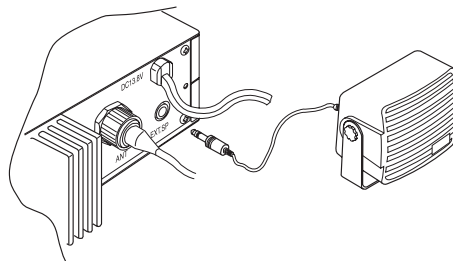

CONNECTING POWER

Follow these steps to power the transceiver from your vehicle's battery.

1. Connect the supplied polarized 13.8V DC power connector to the white power socket and cable on the back of the transceiver. The plug and socket only fit one way. If you can not easily insert the plug, turn it over and try again. Do not force it.

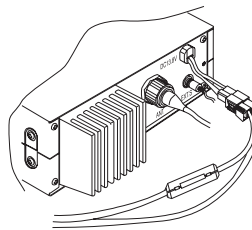

2. Connect the red wire (+) (with the in-line fuse holder) to a point in your vehicle's fuse block that supplies power only when the ignition is in the ACC (accessory) or ON position.
3. Connect the black wire (-) to a metal part of the vehicle's frame (chassis ground).

Caution: Do not connect the black wire to a non-metallic (plastic) part, or to any part insulated from the vehicle's chassis by a non-metallic part.

USING THE TRANSCEIVER AS A BASE STATION

Although this transceiver is designed for mobile use, you can also use it as a base station with a DC power source. To use the transceiver as a base station, you need these items:

- a regulated power supply that supplies at least 7 amps at 12V DC

Caution: Most 12–13.8V DC power supplies operate from a standard AC outlet. Before connecting your transceiver to this type of power supply, read and follow the instructions included with it.

-
-
- a base station antenna
 - coaxial antenna cable and appropriate connectors

Your local RadioShack store carries a wide selection of all products needed to set up your transceiver as a base station.

Follow these steps to use the transceiver as a base station.

1. Mount the base station antenna as described in its owner's manual.

Warning: Use extreme caution when you install or remove a base station antenna. If the antenna starts to fall, let it go! It could contact overhead power lines. If the antenna touches a power line, contact with the antenna, mast, cable, or guy wires can cause electrocution and death. Call the power company to remove the antenna. Do not attempt to do so yourself!

2. Connect the antenna to the PL259 **ANT** connector on the back of the transceiver. If the antenna's plug does not match the **ANT** jack on the back of the transceiver, contact your local RadioShack store for a suitable adapter.

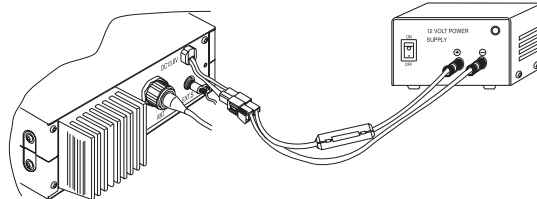

3. Connect the supplied polarized 13.8V DC power connector to the white power socket and cable on the back of the transceiver. The plug and socket only fit one way. If you can not easily insert the plug, turn it over and try again. Do not force it. Then connect the red power wire with the in-line fuse (+) and the black power wire (-) to the appropriate terminals on your power supply.
4. Plug the power supply's AC power cord into a standard AC outlet.

A QUICK LOOK AT THE CONTROLS

Most of the controls on the transceiver have multiple functions. The following charts should help you get a better idea of the function of each control.

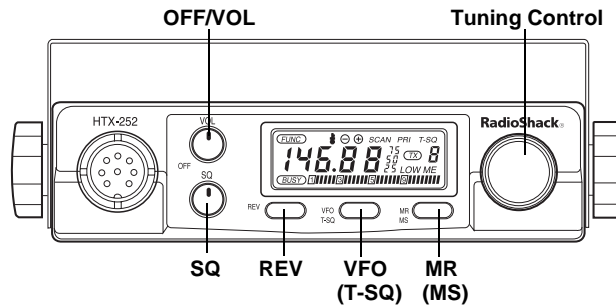

Base Unit		
Key/Control	Use it to:	Use with the F + Key to:
OFF/VOL	Turn the transceiver on/off. Adjust the volume.	Reset the transceiver
SQ	Set the squelch level to block weak signals.	N/A
REV	Reverse the repeater offset.	N/A
VFO (T-SQ)	Set the transceiver to VFO mode.	Set the tone squelch.
MR (MS)	Recall a frequency in memory.	Store a frequency in memory.
Tuning Control	Change the frequency by the set STEP value.	Change the frequency by 1 MHz steps.

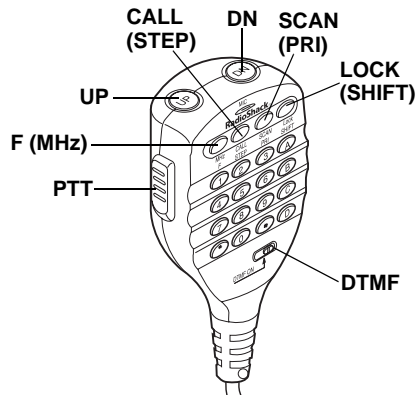

Microphone		
Key/Control	Use it to:	Use with the F + Key to:
Push to Talk (PTT)	Transmit by holding it down. Press to store a setting.	Change the transmitting power to high or low.
UP	Increase the frequency by the selected step value.	Increase the frequency in 1 MHz steps.
DN	Decrease the frequency by the selected step value.	Decrease the frequency by 1 MHz steps.
F (MHz)	Temporarily open the squelch.	N/A
CALL (STEP)	Recall the calling frequency memory.	Set the frequency step.

Microphone		
Key/Control	Use it to:	Use with the F + Key to:
SCAN (PRI)	Start and stop scanning.	Set the transceiver to dual watch mode.
LOCK (SHIFT)	Lock and unlock the controls except PTT , F , VOL , and SQ .	Set the repeater offset.
Alpha-Numeric Keys	Enter numerical values and DTMF control letters.	N/A
DTMF	Switch to DTMF control.	N/A

A QUICK LOOK AT THE DISPLAY

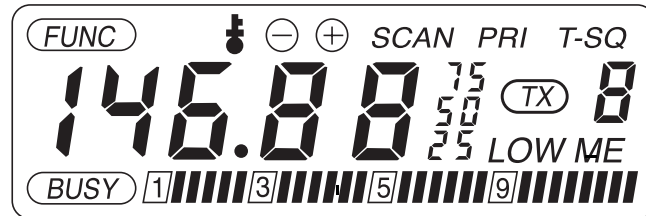

1. **FUNC** — appears when **F** key is pressed.
2. — indicates the keypad is locked.
3. — indicates a negative repeater offset.
4. — indicates a positive repeater offset.
5. **SCAN** — appears when the transceiver is scanning frequencies.
6. **PRI** — indicates a priority frequency.
7. **T** — appears when Tone Squelch (CTCSS) is enabled for transmission only.
8. **T-SQ** — appears when Tone Squelch (CTCSS) is enabled for both transmission and reception.
9. **Alpha-Numeric Display** — shows frequency and operation feature information.
10. **TX** — appears when the transceiver is transmitting.
11. **0 to 9** — shows the memory channel in use.
12. **BUSY** — appears when the transceiver receives a signal.
13. — indicates signal strength; the stronger the signal, the more boxes appear.
14. **ME** — appears when the frequencies and other station data are being stored or while scanning data in memory locations.

Note: When you reset the transceiver, all display elements appear. See “Resetting the Transceiver” on Page 37.

OPERATION

TURNING THE TRANSCEIVER ON AND OFF

To turn on the transceiver, rotate **VOL** clockwise until it clicks. The last used frequency and other settings appear (the default frequency is 142.50 MHz, with a frequency step of 5 kHz/.005 MHz). To turn the transceiver off, rotate **VOL** counterclockwise until it clicks.

SELECTING FREQUENCIES

To select a frequency in the VFO (variable frequency oscillator) mode, use either **UP** or **DN** on the top of the microphone or the tuning control.

Using either method lets you step up or down in increments which you set using the Frequency Step option. (See "Setting the Frequency Step" on Page 33").

Rotating the tuning control changes the frequency by the value of the step you set. You might want to set your preference for the step value before you make other settings. Repeatedly pressing (or holding down) **UP** or **DN** also changes the frequency by the step value. To change the frequency by 1MHz steps, press **F** so **FUNC** appears. Then repeatedly press or hold down **UP** or **DN**.

The displayed frequency is typically shown to two significant decimal places. However, depending upon the selected frequency step, you might see a smaller number displayed to the right of the second place. For example, **142.50₅** lets you see the complete frequency in use if you select 12.5kHz as your frequency step.

RECEIVING TRANSMISSIONS

Follow these steps to receive standard transmissions.

1. With the transceiver on, rotate **SQ** counterclockwise until you hear a hissing sound. Then slowly rotate **SQ** clockwise just until the noise stops.

Notes:

- **BUSY** appears when the transceiver receives a standard transmission or if the squelch is open.
 - If the transceiver picks up unwanted and weak transmissions, rotate **SQ** clockwise to prevent the squelch from opening for these transmissions. If you want to hear weak transmissions, rotate **SQ** counterclockwise. When you do this, you might hear hissing between transmissions.
2. Rotate the tuning control to select a frequency.
 3. Set **VOL** to a comfortable listening level.

TRANSMITTING

There are two basic types of communication possible with this transceiver: radio-direct-to-radio (simplex) or radio-to repeater-to-radio (duplex). Simplex operation uses the same frequency to send and receive. Duplex operation uses one frequency to transmit and another to receive. For more information about duplex, see “Understanding Repeaters” on Page 22.

Caution: It is illegal to transmit if you do not have at least a Technician Class license issued by the FCC.

Follow these steps to transmit.

1. Select the desired frequency using the tuning control or **UP/DN** until you are within the transmit frequency range.

-
-
2. Hold the microphone about 3 inches from your mouth.
 3. Hold down the ribbed transmit button on the side of the microphone, then speak slowly and clearly into the microphone. **TX** appears while you transmit, and signal strength bars appear on the bottom to indicate the relative transmitting signal output.

Note: If you try to transmit outside the transmit frequency range, **E** appears instead of **TX** to indicate you are outside the transmitting range.

4. Release the transmit button when you finish transmitting.

UNDERSTANDING REPEATERS

Operating through a repeater, where you transmit on one frequency and receive on another, is called *duplex* operation. Operating direct to another station, where you transmit and receive on the same frequency, is called *simplex* operation.

A repeater is a station that receives a signal on one frequency (the *input* frequency) and then retransmits that signal on a different frequency (the *output* frequency). Repeater antennas are typically located at the tops of tall buildings or on antenna towers, so a relatively low-power signal can reach the repeater. The repeater retransmits the signal at a higher power. This gives your transceiver the ability to communicate over a much greater range.

To use a repeater, you must know the repeater's input and output frequencies. Repeaters are usually identified by their output frequency. For example, a repeater that has an output frequency of 146.94 is referred to as "the 146.94 repeater." To determine the input frequency, you must know the frequency *offset* (typically 600 kHz for the 2-meter band) and the *offset direction* (+ if you add 600 kHz to the output, or – if you subtract 600 kHz from the output).

Whether the offset is positive or negative depends on:

- which part of the band the repeater operates on
- local convention
- proximity of repeaters using the same two frequencies

To determine the offset and the direction, obtain a copy of *The ARRL Repeater Handbook* (available at your local RadioShack store or directly from the ARRL). That book lists the locations of repeaters as well as their frequency and offset information.

A ⊕ above the displayed frequency indicates a positive offset, while a ⊖ above the frequency indicates a negative offset. If neither ⊕ nor ⊖ appears, the transceiver is set for simplex operation.

SETTING THE REPEATER OFFSET FREQUENCY

Note: This setting affects only the VFO mode. If you saved a repeater offset in a memory, that setting is not affected.

1. Press **F+SHIFT (LOCK)**. The offset frequency and **⊖** appear.
2. While the offset frequency appears, rotate the tuning control or repeatedly press **UP** or **DN** until the desired offset appears. The transceiver's default repeater offset is 600 kHz, which appears as **0.60 (MHz)**. You can select a value from 100 kHz to 8.000 MHz.
3. Press **PTT** to store the setting or wait 5 seconds. The selected value is stored and the operating frequency appears.

SETTING THE REPEATER OFFSET DIRECTION

1. Set an offset frequency.
2. Repeatedly press **F + SHIFT (LOCK)** to change the current offset direction (**⊕** above, **⊖** below, or *neither* for simplex or non-repeater operation).
3. Press **PTT** to store the setting or wait 5-seconds. The selected value is stored and the operating frequency appears.

REVERSING THE TRANSMIT AND RECEIVE FREQUENCIES

To swap the input and output frequencies, press **REV**. For example, if you have set the transceiver to repeater operation on 146.94 MHz with a positive offset of 600 kHz, the transceiver would normally receive on 146.94 MHz and transmit on 147.54 MHz. After you press **REV**, the transceiver is set to receive on 147.54 MHz and transmit on 146.94 MHz.

This feature is useful if you want to determine whether you are close enough to another station to communicate on a simplex frequency. While the other station is transmitting, reverse the frequencies. If you can still hear the other station, you are hearing their signal directly and you do not need to use the repeater.

MEMORY OPERATION

Your transceiver has 10 standard memory locations that you can use to store frequencies for quick access. You can also store other settings for each memory location, such as the repeater offset and the CTCSS tones.

STORING A TRANSMIT/RECEIVE FREQUENCY

1. Select the frequency you want to store by using the tuning control or **UP/DN**.
2. If desired, select an offset frequency, offset direction, and CTCSS frequency for the selected frequency (see “Setting the Repeater Offset Frequency” on Page 23 and “Continuous Tone Coded Squelch System Features” on Page 28).
3. Press **F+MS**. A memory location appears and flashes if empty. To select a different memory location, repeatedly press **UP/DN** or rotate the tuning control.
4. Press **MR**. The transceiver stores the selected settings in the memory location.
5. Press **VFO** to exit the memory mode.

RECALLING MEMORIES

1. Press **MR** so a memory location number appears.
2. Press **UP** or **DN** or rotate the tuning control to select the desired memory location.
3. Press **VFO** to return to the VFO mode.

USING THE CALLING-FREQUENCY MEMORY

The calling-frequency memory location lets you quickly jump to a specific programmed frequency at any time. The default calling frequency is 146.52 MHz. You can store a different frequency into memory as well as other settings associated with that frequency, such as the repeater offset and CTCSS tone.

1. Select the desired calling frequency using **UP/DN** or the tuning control.
2. Press **F+MR (MS)**. A memory location and **ME** appear.
3. Rotate the tuning control or repeatedly press **UP** or **DN** until **C** appears in the memory location area on the display.
4. Press **MR (MS)**. **C** flashes.
5. Press **MR (MS)** again to store the selected frequency.
6. Press **VFO (T-SQ)** to return to the VFO mode.

To enable the calling frequency, press **CALL** at any time. The transceiver immediately tunes to that frequency with the settings you programmed. To exit the calling frequency mode, press **VFO (T-SQ)**.

SCANNING OPERATION

SCANNING FOR ACTIVE FREQUENCIES

1. To search for activity on a frequency, press **SCAN (PRI)**. **SCAN** appears. The transceiver begins to scan up or down the full frequency range. The transceiver stops on each active frequency for 5 seconds if squelch is on. If squelch is off, the transceiver stops on each location for about 1 second.
2. To change the scanning direction, press **UP** or **DN**.
3. To stop on a frequency or to stop scanning completely, press **SCAN** again.

SCANNING STANDARD MEMORY LOCATIONS

1. Press **MS (MR)** then **SCAN**. The transceiver scans all memory locations except empty locations.
2. To change the scanning direction, press **UP** or **DN**.
3. To stop scanning, press **SCAN** again.

CONTINUOUS TONE CODED SQUELCH SYSTEM FEATURES

Your transceiver can transmit and receive a low-level, selectable subaudible tone at the same time as it transmits (TX) or receives (RX) a regular signal. This special tone lets you listen only to other transceivers set to the same tone frequency when you use the transceiver in simplex operation. It also lets you match your transceiver to the subaudible tone frequency used by a local repeater.

To enable the TX and RX tones for the transceiver, follow these steps.

1. Press **F+T-SQ**. The current tone setting and **T** appear. (**T** indicates that only the TX tone is enabled.)
2. Rotate the tuning control or repeatedly press **UP** or **DN** to select a tone frequency from the list on Page 28. About 5 seconds after your last change, the display exits the tone setting mode, stores your tone selection, and the current operating frequency appears again.
3. To enable both the TX and RX tones, repeatedly press **F+T-SQ** until **T-SQ** appears. To disable CTCSS operation, repeatedly press **F+T-SQ** until **T** and **T-SQ** disappear.
4. Press **PTT** to store all the settings.

TEMPORARILY OPENING SQUELCH

If you use the Tone Squelch (CTCSS) feature, you might not hear a transmission on the current frequency. To temporarily open the squelch so you can hear all transmissions on the frequency, hold down **F**. To resume normal operation, release **F**.

Subaudible Tone Frequencies (Hz)

67.0	107.2	167.9
71.9	110.9	173.8
74.4	114.8	179.9
77.0	118.8	186.2
79.7	123.0	192.8
82.5	127.3	203.5
85.4	131.8	210.7
88.5	136.5	218.1
91.5	141.3	225.7
94.8	146.2	233.6
97.4	151.4	241.8
100.0	156.7	250.3
103.5	162.2	

USING DTMF TONES

DTMF (Dual-Tone, Multiple Frequency) is another term for *touch-tones* (the tones a telephone produces when you press a digit). This standard set of tones is used by many different amateur transceiver systems for accessing programmable features and dialing through autopatches to a standard telephone.

Your transceiver produces all 16 standard DTMF tones (0–9, *, #, A, B, C, and D).

Follow these steps to use the DTMF feature.

1. Set **DTMF** on the bottom of the microphone to **ON**.
2. Enter the DTMF sequence using the alphanumeric keys.
3. After you complete your transmission, set **DTMF** to the left position to turn off the feature.

OTHER SPECIAL FEATURES

USING PRIORITY FREQUENCY MONITOR

You can designate one frequency as primary (in either VFO or memory mode) and another frequency as secondary (VFO only). Once you do that, the transceiver tunes the primary frequency or memory location for 5 seconds. Then it checks the secondary frequency for 1/2 second. If the transceiver finds a signal on the secondary frequency, it automatically remains there for 5 seconds before returning to the primary frequency.

Using VFO Priority

1. Select the desired secondary frequency using the tuning control or **UP/DN**.
2. Press **F+PRI (SCAN)**
3. Select the primary frequency using the tuning control or **UP/DN**. The transceiver starts to monitor both selected frequencies.
4. To disable priority monitor, press **F+PRI (SCAN)** again.

Using Memory Priority

1. Select the desired secondary VFO frequency using the tuning control or **UP/DN**.
2. Press **F+PRI (SCAN)**
3. Press **MR (MS)** then select the desired memory location for your primary frequency. The transceiver starts to monitor both selected frequencies.
4. To disable priority monitor, press **F+PRI (SCAN)** again.

CHANGING THE TRANSMIT FREQUENCY RANGE

You can change the standard transmit frequency range from 144–148 MHz to an extended range of 142.000–149.885 MHz.

To set the transceiver to its extended range, turn it off. Then while holding down **F** and **LOCK**, turn on the transceiver.

To return to the standard frequency range, repeat the above procedure.

SELECTING THE TRANSMIT POWER LEVEL

You can select either of two transmitting power levels: high (25 watts) for normal operation or low (10 watts). Choose the lower level to reduce the possibility of overloading nearby receivers. Choose the higher level when conditions warrant maximum transmitting power. To switch levels, press **F+PTT**. If low is selected, **LOW** appears. If high is selected, **LOW** disappears.

LOCKING THE KEYPAD

To lock the transceiver's keypad so you do not accidentally change a setting, press **LOCK (SHIFT)**. **!** appears. This locks all controls except **PTT**, **F**, **VOL**, **SQ**, and **LOCK**.

To unlock the keypad, press **LOCK** again.

TURNING THE KEY TONE ON AND OFF

The transceiver is preset to sound a beep each time you press a key. To turn off the beep, hold down the PTT button while you turn on the transceiver's power. To restore the key tone, repeat the procedure.

SETTING THE FREQUENCY STEP

To change the frequency increment used during scanning and stepping to a frequency, press **F+STEP (CALL)**. The current frequency step appears. Then repeatedly press **UP** or **DN** or rotate the tuning control to change the setting. The default is 5 kHz. You can change the frequency step to 5 kHz, 10 kHz, 12.5 kHz, 15 kHz, 20 kHz, or 25 kHz.

REDUCING INTERFERENCE

Because your transceiver is exceptionally quiet, any noise you hear probably originates from a source within your vehicle such as the alternator, the spark plugs, or unshielded wires.

To solve the problem, you must locate the noise's source. You can determine the noise's source by first turning off the engine and operating the transceiver with your vehicle's ignition set to ACC. If the noise decreases or disappears completely, the problem is with your vehicle's ignition or associated wiring.

Here are a few suggestions to help you reduce or eliminate such noise:

- Make all of the transceiver's power and antenna wires as short and as direct as possible.
- Route the power wires away from the antenna wires.
- Be sure the chassis ground connection is secure.

-
-
- Replace old ignition wires with new, high-voltage, noise suppression wires.
 - Install noise suppressors on your spark plugs, or install new spark plugs that have built-in noise suppressors.
 - If problems persist, check to ensure your alternator and electrical system are operating correctly. You can reduce any noise by using bypass capacitors at the various output voltage points.

Your local RadioShack store carries a wide selection of capacitors and other appropriate noise reduction components.

TROUBLESHOOTING

If your transceiver is not working as it should and it displays an error message, these suggestions might help you eliminate the problem. If the transceiver still does not operate properly, take it to your local RadioShack store for assistance.

Symptom	Possible Cause and Solution
Problems with reception	<p>Squelch setting too high. Adjust as needed.</p> <p>Tuned to a non-operating frequency. Tune to an active frequency.</p> <p>Antenna not properly attached. Check and reconnect if needed.</p> <p>Poor antenna cable connections. Check connections and repair or replace as needed.</p>
Problems with transmission	<p>Poor antenna cable connections. Check connections and repair or replace as needed. Check all connections for corrosion and clean if necessary.</p> <p>PTT button not fully pressed. Press firmly and hold down when transmitting.</p> <p>Microphone connection loose. Secure the connection.</p>
No Power	<p>Check fuse. Replace if blown.</p> <p>Check power cables and connections. Repair or replace if broken or disconnected.</p>

CARE AND MAINTENANCE

Your RadioShack 2-Meter FM Mobile Amateur Transceiver is an example of superior design and craftsmanship. The following suggestions will help you care for your transceiver so you can enjoy it for years.



Keep the transceiver dry. If it gets wet, wipe it dry immediately. Liquids might contain minerals that can corrode the electronic circuits.



Use and store the transceiver only in normal temperature environments. Temperature extremes can shorten the life of electronic devices, damage batteries, and distort or melt plastic parts.



Keep the transceiver away from dust and dirt, which can cause premature wear of parts.



Handle the transceiver gently and carefully. Dropping it can damage circuit boards and cases and can cause the transceiver to work improperly.



Wipe the transceiver with a damp cloth occasionally to keep it looking new. Do not use harsh chemicals, cleaning solvents, or strong detergents to clean the transceiver.

Modifying or tampering with the transceiver's internal components can cause a malfunction and might invalidate its warranty and void your FCC authorization to operate it. If your transceiver is not performing as it should, take it to your local RadioShack store for assistance.

RESETTING THE TRANSCEIVER

If the transceiver's display locks up or the transceiver does not work properly after you turn it on, you might need to reset it.

Important: This procedure clears all the information you have programmed into the transceiver. Before you reset the transceiver, try turning it off then on again to see if it begins working properly.

To reset the transceiver, turn it off then hold down **F** and turn it on again. All display elements appear, confirming the reset operation. Release **F**.

REPLACING THE IN-LINE FUSE

The transceiver (and vehicle) are protected by a 10-amp fuse in the transceiver's positive (red) power wire. If the transceiver does not turn on, check the fuse and replace it to be certain.

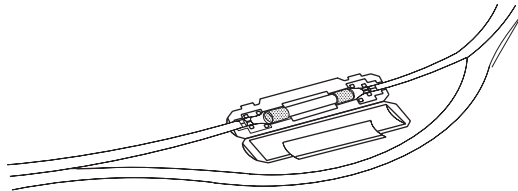

Follow these steps to check or replace the fuse,

1. Make sure the transceiver is off.
2. Snap open the in-line fuse holder by applying thumb pressure in opposite directions on the seam lock.
3. Remove the fuse from the holder and slide the fuse out of the end connectors.
4. If the fuse's filament is blown, replace the fuse with one of the same type and rating. Then snap the cover closed.

SPECIFICATIONS

GENERAL

Frequency:	
TX	144.000–148.000 MHz
Extended TX Range	142.000–149.885 MHz
RX	136.000–174.000 MHz
Frequency Control	Digital PLL Synthesizer
Display Type.....	LCD
Operating Temperature	–4° to 122°F (–22.5° to 49.5°C)
Power Requirements	13.8VDC (12–16V DC, negative ground)
Antenna	50-ohm (coaxial connector)
Dimensions (HWD)	1 ¹ / ₄ × 5 ³ / ₂₅ × 5 ¹ / ₂ inches (32 × 130 × 140 mm)
Weight	1.54 lb. (0.7 kg)

RECEIVER

Sensitivity	0.22 µV for 10 dB S/N
Overload Audio Fidelity @ 6dB Down.....	450–2100 Hz
Adjacent Channel Selectivity	60 dB
Spurious and Image Rejection	60 dB Min.
Maximum Audio Output Power.....	2.5 watts @ 8-Ohm load
Squelch Tight Range	0.5 m to 1 mV
Battery Drain:	
No Signal	300 mA
Maximum Output	600 mA

TRANSMITTER

Max Power Output:

High 25 watts
Low 10 watts
Spurious Emission Better than -65dB
Deviation ± 5 kHz

Battery Drain:

High 5A
Low 3A

Specifications are typical; individual units might vary. Specifications are subject to change and improvement without notice.

Limited One-Year Warranty

This product is warranted by RadioShack against manufacturing defects in material and workmanship under normal use for one (1) year from the date of purchase from RadioShack company-owned stores and authorized RadioShack franchisees and dealers. EXCEPT AS PROVIDED HEREIN, RadioShack MAKES NO EXPRESS WARRANTIES AND ANY IMPLIED WARRANTIES, INCLUDING THOSE OF MERCHANTABILITY AND FITNESS FOR A PARTICULAR PURPOSE, ARE LIMITED IN DURATION TO THE DURATION OF THE WRITTEN LIMITED WARRANTIES CONTAINED HEREIN. EXCEPT AS PROVIDED HEREIN, RadioShack SHALL HAVE NO LIABILITY OR RESPONSIBILITY TO CUSTOMER OR ANY OTHER PERSON OR ENTITY WITH RESPECT TO ANY LIABILITY, LOSS OR DAMAGE CAUSED DIRECTLY OR INDIRECTLY BY USE OR PERFORMANCE OF THE PRODUCT OR ARISING OUT OF ANY BREACH OF THIS WARRANTY, INCLUDING, BUT NOT LIMITED TO, ANY DAMAGES RESULTING FROM INCONVENIENCE, LOSS OF TIME, DATA, PROPERTY, REVENUE, OR PROFIT OR ANY INDIRECT, SPECIAL, INCIDENTAL, OR CONSEQUENTIAL DAMAGES, EVEN IF RadioShack HAS BEEN ADVISED OF THE POSSIBILITY OF SUCH DAMAGES.

Some states do not allow limitations on how long an implied warranty lasts or the exclusion or limitation of incidental or consequential damages, so the above limitations or exclusions may not apply to you.

In the event of a product defect during the warranty period, take the product and the RadioShack sales receipt as proof of purchase date to any RadioShack store. RadioShack will, at its option, unless otherwise provided by law: (a) correct the defect by product repair without charge for parts and labor; (b) replace the product with one of the same or similar design; or (c) refund the purchase price. All replaced parts and products, and products on which a refund is made, become the property of RadioShack. New or reconditioned parts and products may be used in the performance of warranty service. Repaired or replaced parts and products are warranted for the remainder of the original warranty period. You will be charged for repair or replacement of the product made after the expiration of the warranty period.

This warranty does not cover: (a) damage or failure caused by or attributable to acts of God, abuse, accident, misuse, improper or abnormal usage, failure to follow instructions, improper installation or maintenance, alteration, lightning or other incidence of excess voltage or current; (b) any repairs other than those provided by a RadioShack Authorized Service Facility; (c) consumables such as fuses or batteries; (d) cosmetic damage; (e) transportation, shipping or insurance costs; or (f) costs of product removal, installation, set-up service adjustment or reinstallation.

This warranty gives you specific legal rights, and you may also have other rights which vary from state to state.

RadioShack Customer Relations, 200 Taylor Street,
6th Floor, Fort Worth, TX 76102

We Service What We Sell

12/99

RadioShack
A Division of Tandy Corporation
Fort Worth, Texas 76102